

FL "SystComb"

Application system for:

COBERLAN



TERMOLAN

ISOLAMENTOS TERMO-ACÚSTICOS, S.A.

DEFINITION:

Application system of rigid and high density slabs of uniform thickness (min. 50 mm) with the 4 edges pre-cutted.

APPLICATIONS:

Suitable solutions to provide a fire barrier in insulation systems combined with combustible insulations (EPS, XPS, PIR, PUR), being used under the mechanical fixing waterproofing membrane, so that, with less weight and safety, is guaranteed the higher performance of flat roofs for new and / or rehabilitation buildings.

BENEFITS:

- Lighter insulation;
- Easy and quick application;
- High insulation performances;
- Excellent mechanical behaviour:
 - High compressive traction strength resistance;
 - Very good perpendicular traction strength behaviour;
 - High resistance to rupture (excellent support for steel profiles with big gaps);
- Fire safety;
- Excellent water behaviour;
- Inert product respecting the environment (CFC and HCFC free).

PRESENTATION:

Slabs: Options of presentation:

THICKNESS (mm)	DIMENSIONS (mm) [NP EN 823]	USEFUL DIMENSIONS (mm) [NP EN 822]
Depending on the application system as well as the slope	1200x1000	1175x975
	1200x1200	1175x1175

Tolerances:

THICKNESS (CLASS T5): -1% OR -1 mm ^{a)} TO +3 mm

LENGTH: ±2%

WIDTH: ±1.5 mm

^{a)} Is valid the greatest numerical tolerance

PACKAGING:

Slabs packed in retractable plastics under pallets. Geometry (AxBxH):

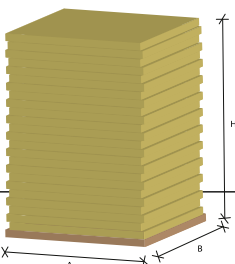

PHYSICAL PROPERTIES OF MATERIALS

MAIN CHARACTERISTIQUES

Consult the following product technical files for information of the physical properties:

COBERLAN N50

COBERLAN N75

COBERLAN N50F

COBERLAN DD

COBERLAN C

COBERLAN POWER

EXAMPLES OF FL "SYSTCOMB" SYSTEMS

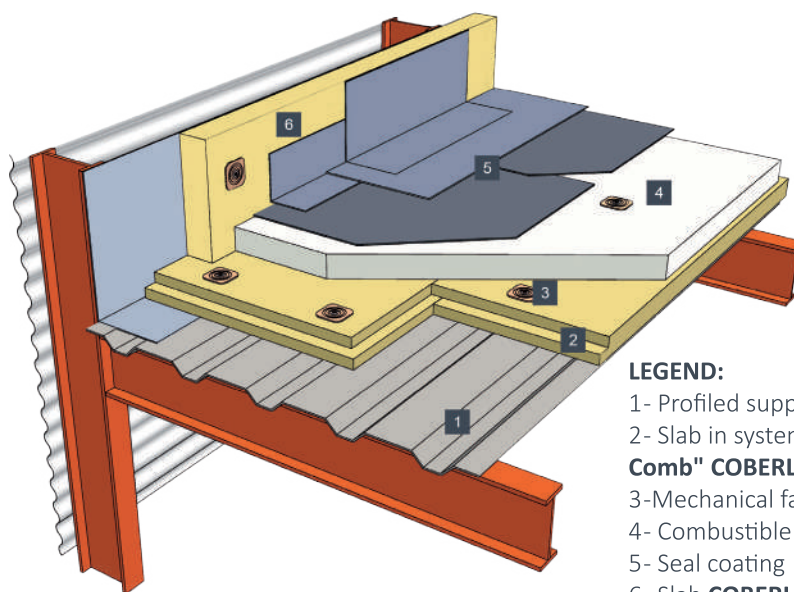

LEGEND:

- 1- Profiled support steel plate
- 2- Slab in system FL "SystComb" COBERLAN
- 3-Mechanical fastening;
- 4- Combustible insulation
- 5- Seal coating
- 6- Slab COBERLAN

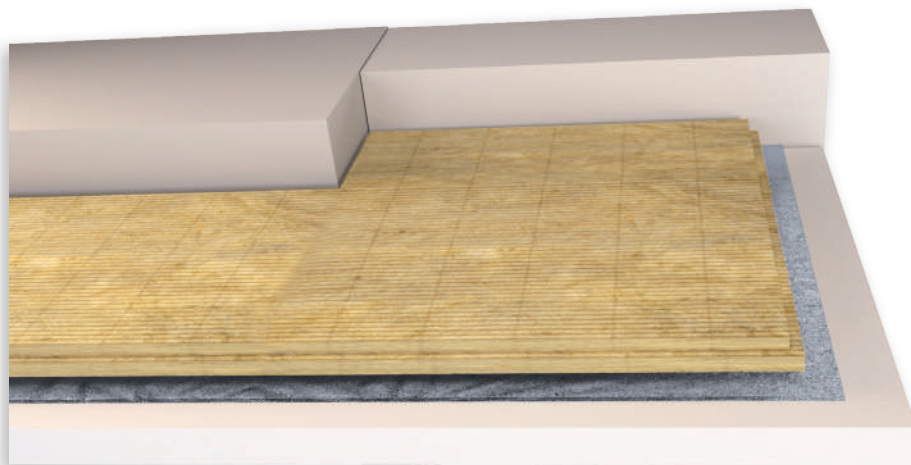

TERMOLAN

www.termolan.pt/en | www.rocterm.com | termolan@termolan.pt